

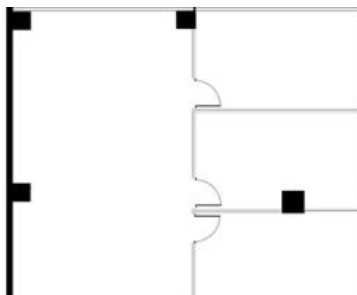

Level 11, Suite 56/88 Pitt Street, Sydney



Front Fitted Suite - Near Martin Place

- 52 sqm
- Front Suite
- Fitted suite with 3 offices and open plan area
- Furniture can be left (Cabled desks)
- Individually controlled air conditioning
- Great natural light
- Outlook onto Pitt Street
- On floor kitchenette
- Access to roof top terrace
- Close to Circular Quay and Wynyard

Price	\$36,400 + GST pa
Property type	Commercial
Property ID	37

Agent Details

Robin Simpson - 0426 251 234

Office Details

Your Office
Suite 17.04, Level 17, 109 Pitt Street
Sydney, NSW, 2000 Australia
0426 251 234



Location - 88 Pitt Street, Sydney is superbly located in the heart of Sydney's Central Business District. The property is ideally positioned in relation to Sydney's financial and banking precincts and within a short walking distance to George Street, the Sydney Stock Exchange, Futures Exchange and some of the City's major commercial landmarks, such as, the MLC Centre, Australia Square and Chifley Tower. Wynyard and Martin Place Stations are nearby. Circular Quay ferry terminal is located only minutes